

Important - this document must be given to the customer

1. FOREWORD

Inwild thank you a lot for having decided to ride and purchasing our free touring telemark binding.

Skiing and telemarking is your passion but by nature it's a dangerous sport. You must understand and accept the risks you take before you engage in it. You are entirely responsible for your actions and your decisions. On skis you must show prudence and discernment. Read carefully and completely this document.

The Telemark bindings of Inwild integrate a release mechanism, which is not validated by a norm. These bindings should release in the case of a fall if they are correctly used with shoes and skis in good condition. However because of the specificity of the Telemark a case could arise where the release is not guaranteed which could cause serious injuries with unpredictable consequences. MEIDJO considerably reduces the risk of injuries to lower limbs, but cannot completely exclude it.

- When you ski please follow the usual recommendations in the practice of this sport and always control your skiing, in function of your capacities and your physical condition, never overestimate your skill.
- Make enquiries as to the blanket of snow conditions, meteorological conditions and risks of avalanche. Respect the instructions and signals of danger in the zone in which you ski.
- Do not tour or telemark if you feel tired or in bad physical form.
- When using a leash always use Inwild leash.
- During transport or storage always protect your material, especially your binding, from exterior aggressions (shocks, dust, salt,...)
- Always store your material in a clean and dry place.
- Regularly control your bindings and check their correct functioning before each sortie. Make sure there is no foreign body in the mechanism. Any foreign body in the mechanism of the bindings could cause problems in the release.
- In case of doubt, wear or corrosion, please have your bindings verified by a store registered with Inwild Equipment. Have your material controlled by a specialized retailer at least once a year, and at the beginning of every season, your whole equipment: skis/shoes/bindings (general state and adjustment of release values).
- The binding has to be directly mounted onto the ski. No other equipment, except Inwild plate, has to be mounted between the ski and the binding.

Before using the MEIDJO bindings:

- Please read carefully all notices and warnings included,
- Assure that you are familiar with their correct utilization, possibilities and limits,
- Try out the use of the telemark bindings and associated material,
- Learn the appropriate techniques for this type of skiing.

The fact of not reading or not respecting any one of these warnings could be the cause of serious injury « leading to possible death».

We have included in this manual all the precautions and stages to be respected for the correct adjustment and functioning of these bindings

In case of doubt or if you need assistance contact your reseller. You can join our technical service at the following address: support@inwildoutdoor.com

The bindings are delivered with a set of screws; on option it is possible to order stainless steel inserts with metrical thread. The MEIDJO binding is compatible only with shoes guaranteed NTN (New Telemark Norm) with Low Tech insert.

2. PREPARATION

There are 2 sizes of binding:

- Size S for shoe with a length between 275 and 298 mm (mondopoint 22,5 à 26),
- Size L for shoe with a length between 305 mm and 336 mm (mondopoint 26,5 à 31).

You have to check that:

- Shoes conform to NTN norms NTN* (New Telemark Norm) and with Low Tech insert,
- The release regulation corresponds to the weight and skill level of skier,
- Screws or inserts are compatible with the skis on which the bindings will be assembled.

Ski

- Most skis on the market have a reinforced plate for a better anchoring of the bindings. Follow the recommendations of the Ski manufacturer before drilling.
- The dimensions of the drill to be used and the depth of piercing are marked on the ski.
- Be sure to verify the marks on the 2 skis before drilling.
- Be sure to protect the soles of the skis before beginning.

Set of tools

To assemble the MEIDJO bindings you will need the following tools:

- 1 Jig from Inwild or 1 drilling pattern from Inwild
- 1 drill 3,6 mm X 9
- 1 wood tap 5,5 mm
- 1 screwdriver PZ N°3
- 1 tube of binding ski glue

Contents of the box

- 2 bindings (including heel set)
- 4 supplementary springs
- 8 screws 18 mm
- 4 flat screws 16 mm
- 14 screws 11,5 mm
- 2 amortizers (S or L)
- 2 touring base plate
- 1 Allen wrench 3mm
- 2 drilling pattern
- This notice

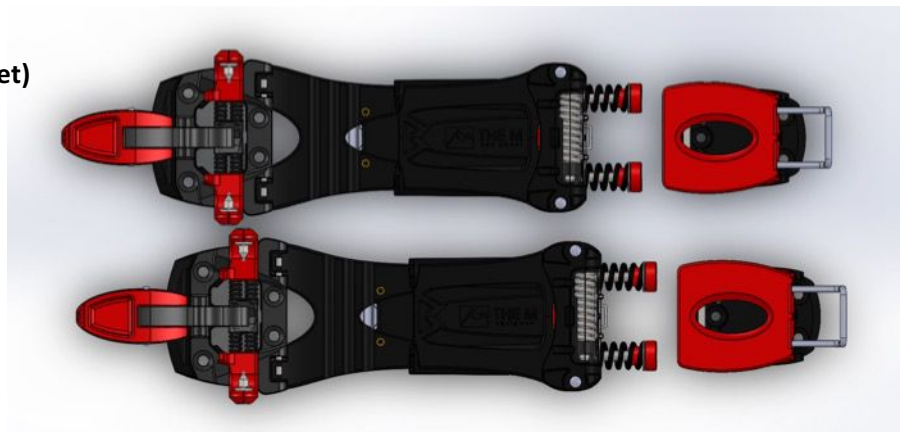

Picture of a pair binding with its material (spring, amortizers and screws)

*Compatible with NTN Rotofella system

3. DRILLING THE SKIS

1. Drilling the skis with Inwild JIG

Preparation of the Jig

- **Unlock the tow black knobs**
- **Place the shoe onto the Jig**
- **Adjust the plates at the shoe size.**
- **Lock the 2 black knobs**
- **Remove the shoe from the Jig**

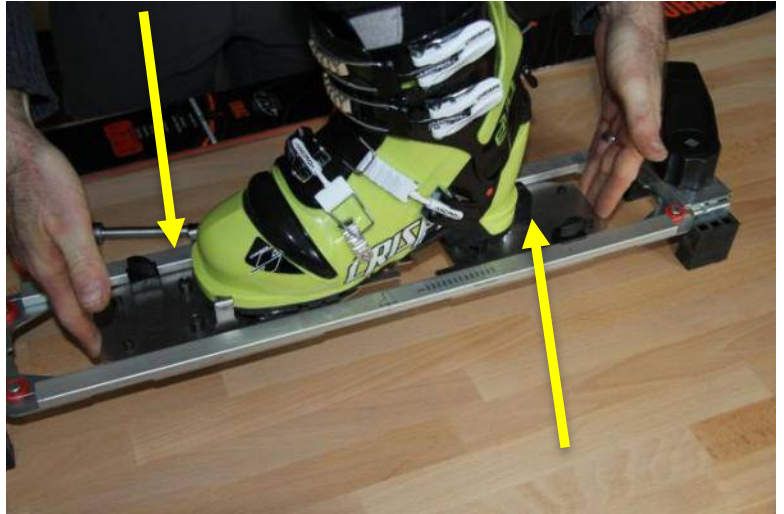

Placing the Jig onto the ski

- **Open the blocking-jaws by turning the handles**
- **Place the Jig so that shoe center line is aligned with the ski center mark.**



2. Drill with the Inwild drilling pattern

Nota : In case you use a printed drilling pattern, check with a ruler that the length line of 200 mm is correct.

- **Read the instruction of the drilling pattern**
- **Check on your shoe the size of the shell in mm**
- **Mark on your ski the middle center of the ski and longitudinal line (on a paper scotch for example)**
- **Cut the drilling pattern as shown - Part A and B**
- **Mark the line corresponding to the size of your shell**
- **Place Part A of the drilling pattern in such a way that the line of marking (value of the length of your shoe) is placed on the mid center line of the ski.**

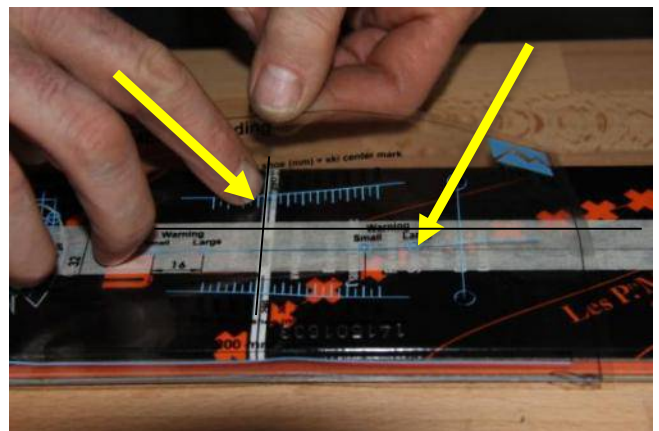

- Take care to align the longitudinal lines
- Place part B of drilling pattern B superposing the mid center line and the mark of the size of your shell.

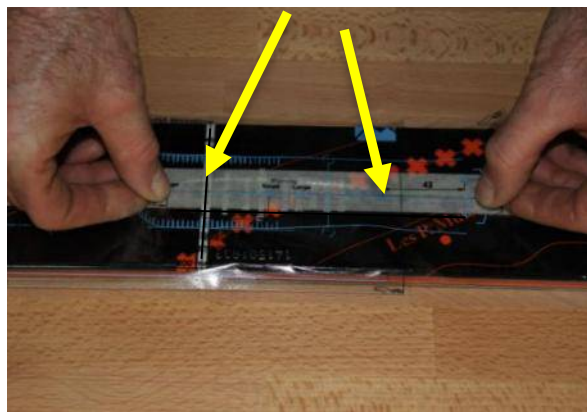

- Verification of the good positioning of the drilling pattern
- Control of the shoe size - place the shoe onto the pattern the front and the back of the shoe has to match with the indication.

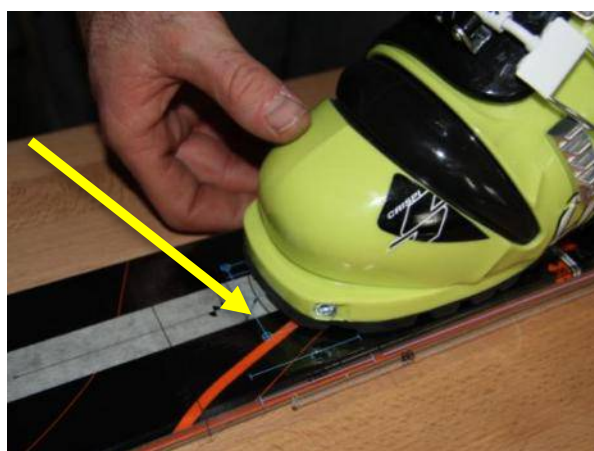

3. Drilling and tap

Nota: Follow carefully the ski manufacturer's recommendations for the dimension of the drill. Inwild recommend a 3.6 Ø drill to get the best thread retention based on the minor diameter of the screw.

Always check the right positioning of the drill pattern before to drill.

- Drill the 4 holes of the front toe piece
- Drill the 4 holes of the headband tensioner
- Drill the 2 holes of the equipping touring/step in base plate
- Drill the 3 holes of the heel set
- Tap the 13 holes - take care to do it correctly
- Clean the 13 holes

4. Cleanliness

Be sure to remove any dust or shards from the drilled hole. It is important to use clean screws, without any chunks of material embedded from a previous mount. A screw with smooth threads ensures proper thread cutting when you turn the screw in. It is also important to apply adequate downward pressure when starting the screw so the threads cut immediately and don't spin and grind away the first engagement. Tapping the hole first is never a bad practice regardless of metal or not. When mounting thinner skis that require the screws to be ground down shorter,

be extra careful to grind a slight taper and to avoid leaving any sharp burrs which will not cut a smooth thread into the ski.

5. Gluing

We recommend using epoxy for Meidjo mounts. Epoxy can increase your overall maximum pullout strength, but most importantly acts as a buffer to decrease screw-loosening possibilities. This in turn can lead to a degradation of the ski's core and increase peak shock loads that will eventually result in the binding ripping out of the ski. For alpine and alpine touring bindings, if you don't prefer epoxy, use simple wood glue to seal the hole and lubricate the screw as it is being twisted in to help achieve suitable clamping force for given torque values.

- **Gluing allows a better screwage and avoids in one case that the binding becomes unscrewed, and in another case this prevents water from penetrating into the ski. It is preferable to use fixation glue, and on no account rubber glues.**
- **Apply the glue in small quantities inside of the holes**
- **Take the pieces to be screwed, put a little glue on the screw and screw with a screwdriver until the pieces are well fixed on the ski. When the binding is fixed in place, make a 1/8 turn on each screw.**

Screwing

Nota: If you are using a screwing machine regulate it on 5Nm maximum and always finish by last wrench by hand. We recommend hand tightening each screw with a TLD-enabled hand posi-driver, making sure that each screw goes directly and perpendicularly in and then doing a final torque spec twist on each screw.

RECAP OF THINGS NOT TO DO:

- Don't re-use old screws that have crap plug in the threads. When you screw that into a new ski you are cutting crappy threads into the core and compromising strength.
- If you need to grind screws for some reason (e.g., the ski is thinner than the screw design provided), be extremely careful not to leave any burrs—these will mess with the thread cutting of the ski core.
- If you get a spinner and strip a hole, don't half-ass it—fix it right by putting an insert in.
- Don't reverse bend the ski when applying drilling pressure. Support it from beneath so that the screw hole is perpendicular to the ski. Even a small amount of flex will change the angle and you'll lose full pullout strength potential.
- **Don't grind out your initial hole threads by carelessly spinning the screw without downward applied force.**

4. MOUNTING THE BINDING

1. Unscrew the 2 red knobs and remove the 2 springs (black one)
2. Remove the spring box
3. Put the glue into the 13 holes



4. Fixed the touring/step in base plate with 2 x 11,5 mm screws. Use a PZ N°3 Screwdriver.
5. Place and fixe the heel set with 3 x 11,5 mm screws by screwing first the front screw first. Use a PZ N°3



6. Verify that the heel set spring is place inside the heel set.



Check that the spring is not visible

7. Install the base plate with the headband plate and take care to well place the rubber guide and the headband like on the picture below.

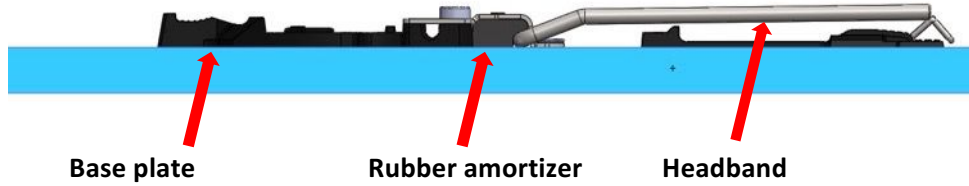

Nota: There is 2 models of rubber one for size S and one for size L

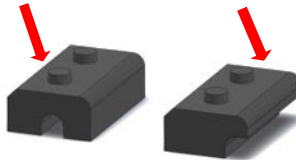

8. Screw the base plate and headband plate with 2 x 16mm flat head screws and 2 x 11,5 mm screws.

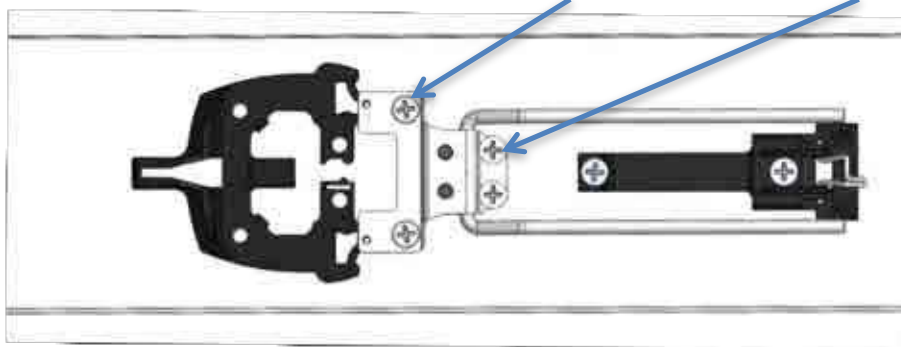

9. Place de Low tech and screw it with 4 x 18 mm screws. Use a PZ N°3 Screwdriver.

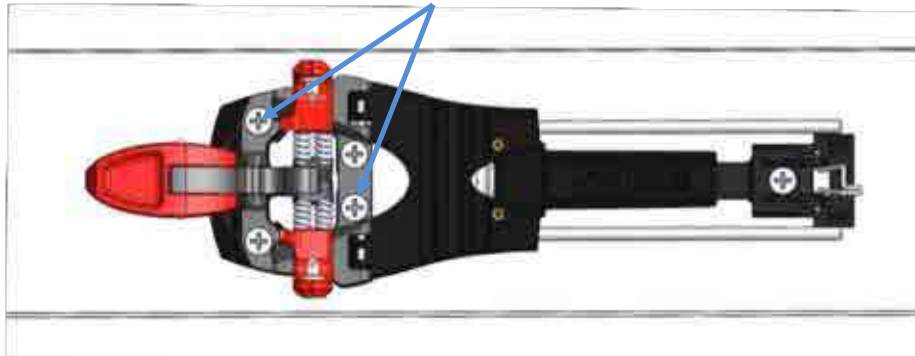

10. Remount the springbox by sliding simultaneously the headband and Flextor



11. Remount the 2 springs
12. Screw the 2 red knobs with the two washers

13. Adjust the spring tension and the safety release system. Align the washer between the red knob and the spring with the line number or the setting you want from 1 to 5. Do not unscrew below setting level 1 during telemark.

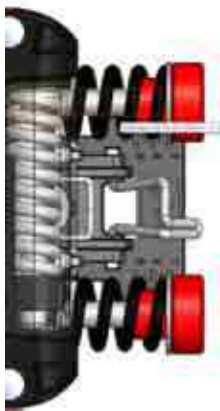

Adjust to level 1
(washer and number 1 aligned)

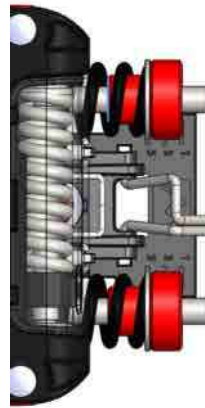

Adjust to level 5
(washer and number 5 aligned)

5. ADDING THE SECOND SPRING

If you want to increase the power of your binding you can add the second spring.

The second spring has to be slide in the bigger one (black one). The steps to do that are:

- Unscrew the 2 red knobs and remove the 2 black spring
- Slide the small stainless steel spring inside each black spring
- Put the 2 pairs of spring inside the spring box
- Screw the 2 red knobs with the two washers



SETTING OF MEIDJO BINDINGS

The particularity of the Meidjo binding is the possibility to adjust separately the heel traction and the sensibility of the release in the case of a fall.

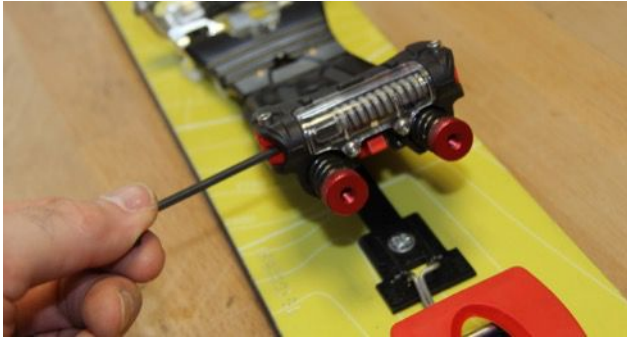

The regulation of the return of the heel is made with the 2 red toothed wheels ; the more you tighten, the more the shoe will have difficulty in pivoting on the front. The Meidjo binding is supplied with 2 extra springs allowing to harden this movement a little more.

The regulation of the sensitivity of the release in case of a fall is made with the Allen screws 3mm on the side of the binding

Attention: ANTI Clockwise to increase the hardness of release.

6. FITTING AND UNFITTING

1. Fitting: "arm" the binding by raising the spring box till the spring box stay upward till the "clac". The red stub axle stands the spring box up.



Then place the shoe in such a way that the toes of the shoe touch the 2 Easy step In pine situated on the front of the jaws. Press the front of the shoe. When the low tech is locked press down your heel slowly. When you hear a little click lift up your heel one time. When you hear a second click, you are fitted into the binding let's telemark.



Touch the easy step in positioner in with the toe of the shoe

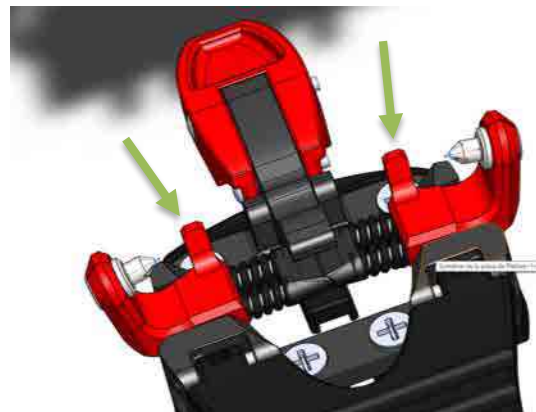

Easy step In positioner

Then press down the heel of your shoe till the first “clac” then raise up till 2nd “clac”. **Let’s telemark**



2. Unfitting

Use your pole to press onto the front lever and reduce pressure onto the toes – the jaws will open automatically.

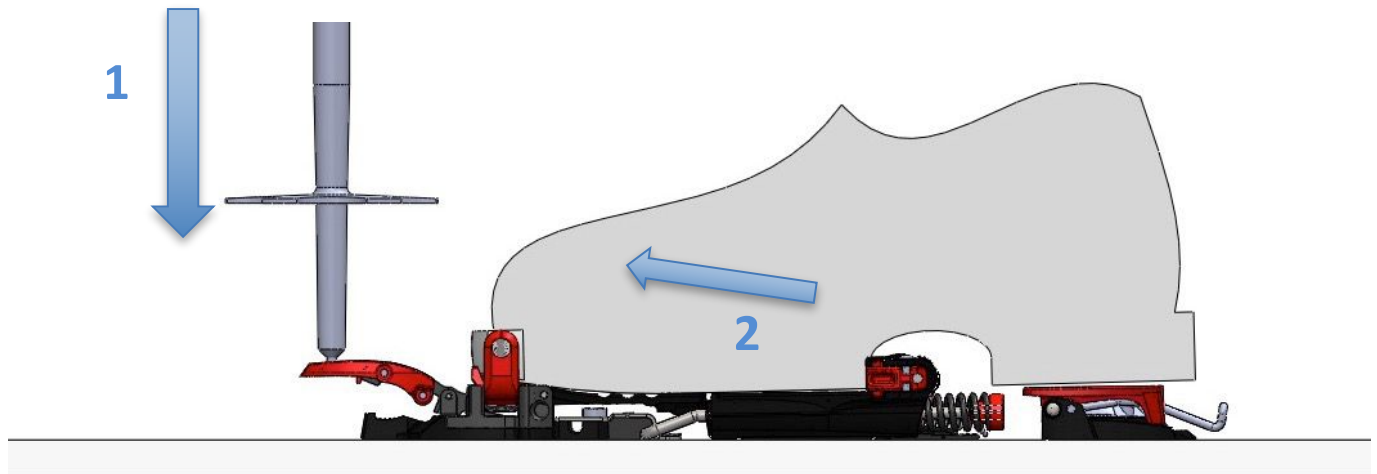

Press the lever with the pole and after move the front of your shoe upward

3. Touring Mode

Preparing the binding:

1. Raise the spring box until the red stub axle settles firmly on the touring base plate like for fitting the binding (see point 1)
2. Press the springbox onto the ski
3. Lock the springbox onto the ski by raising up the touring hook
4. Fit the toe of the shoe onto the lowtech
5. Block the toe of the shoe by raising up the front lever

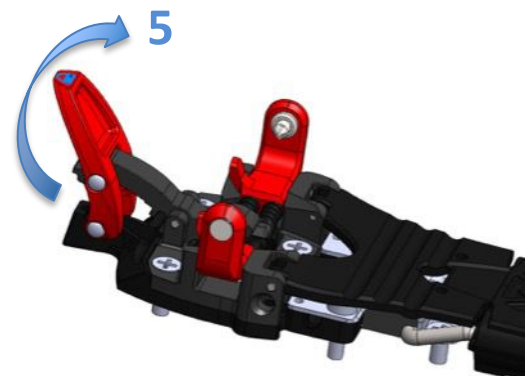
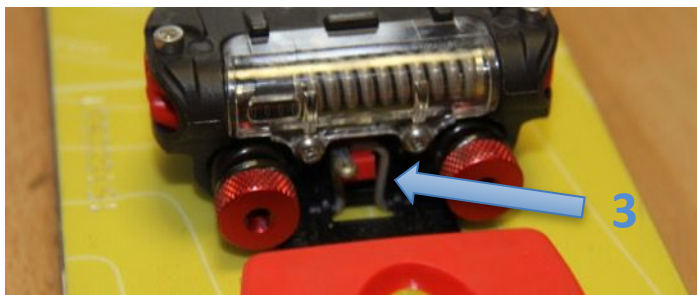

Attention: Once you are in touring mode it is impossible to unfit. Always unlock the front lever as soon as you telemark. **Not respect this instruction could cause serious injury.**

4. The climbing heel set

2 heights of block are available

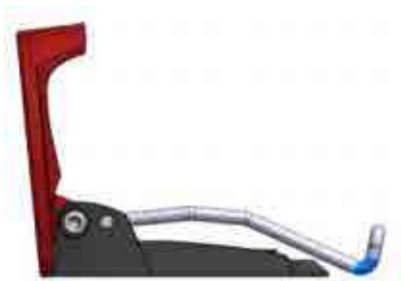

7° (35 mm)



13° (55 mm)

5. Return to telemark mode

To return to telemark mode, you have to unlock the springbox and unlock the lowtech.

1. To unlock the springbox you have to press onto the touring hook lever
2. Unlock the lowtech for your safety

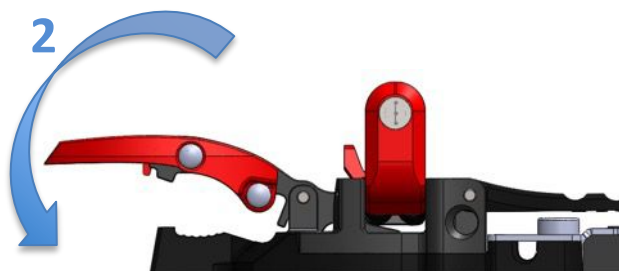
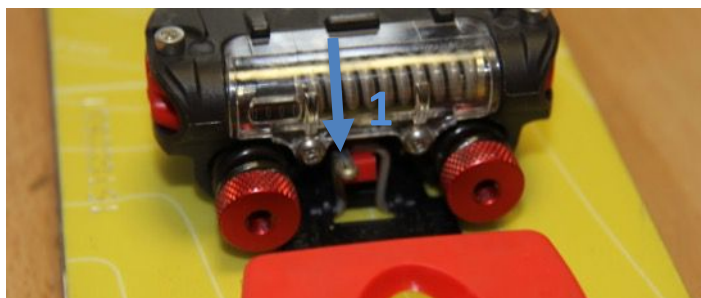

• MAINTENANCE

Your MEIDJO Bindings come ready to ski and should provide years of performance with minimal maintenance. Salt from roads, dirt and grime all work against the life of a binding. Rinse only with freshwater, if required. Keep solvents and chemicals away from your bindings and skis—they can damage plastics and metal components. The arch springs have been lubricated with a cold-weather grease. While this should last a long time, periodically this can be reapplied to keep arch action smooth and help prevent icing in that region. Care should be taken to avoid the grease contacting other parts of the binding. If you have any problem please bring your bindings to A Inwild dealer for service or contact us at www.inwildoutdoor.com.

• GUARANTEE

We warrant for one year from purchase date and only to the original retail buyer (Buyer) that our products (Products) are free from defects in material and workmanship. If Buyer discovers a covered defect, Buyer should return the Product to the place of purchase. In the event that this is not possible, return the Product to us at the address provided. The Product will be repaired or replaced at our discretion. That is the extent of our liability under

this Warranty and, upon expiration of the applicable warranty period, all such liability shall terminate. We reserve the right to require proof of purchase for all warranty claims. You have be registered onto Inwild Website : www.inwildoutdoor.com

Warranty Exclusions:

We do not warranty Products against normal wear and tear (such as ski edge cuts and abrasions, outsole wear, etc.), unauthorized modifications or alterations, improper use, improper maintenance, accident, misuse, negligence, damage, or if the Product is used for a purpose for which it was not designed. This Warranty gives you specific rights, and you may also have other rights, which vary from state to state. Except for expressly stated in this Warranty, we shall not be liable for direct, indirect, incidental, or other types of damages arising out of, or resulting from the use of Product. This Warranty is in lieu of all other warranties, express or implied, including, but not limited to, implied warranties of merchantability or fitness for a particular purpose (some states do not allow the exclusion or limitation of incidental or consequential damages or allow limitations on the duration of an implied warranty, so the above exclusions may not apply to you).

The guarantee doesn't cover in any case the costs of immobilization, accommodation, transport, loss of business, etc...

Conditions of the application of the guarantee

- **To be registered onto Inwild Website: www.inwildoutdoor.com**